

The Highlands at

APPLE TREE POINT

**Fast ferry to Seattle
- 33 minutes!
Coming Soon!**

Now selling shy 1/2-acre home-sites! Build your dream home now with our team of custom home builders & design experts. From the mid 400's. We listen. Reserve yours today.

Pricing:

Available for Presale Customs

Lot 14, 15, 19	\$95,000
Lot 16, 18	\$99,500
Lot 22	\$103,000
Lot 21	\$106,000

Phase A

Lot 1.	\$86,000
Lot 2.	\$88,000
Lot 3.	\$88,000
Lot 4.	\$88,000
Lot 5.	\$93,000

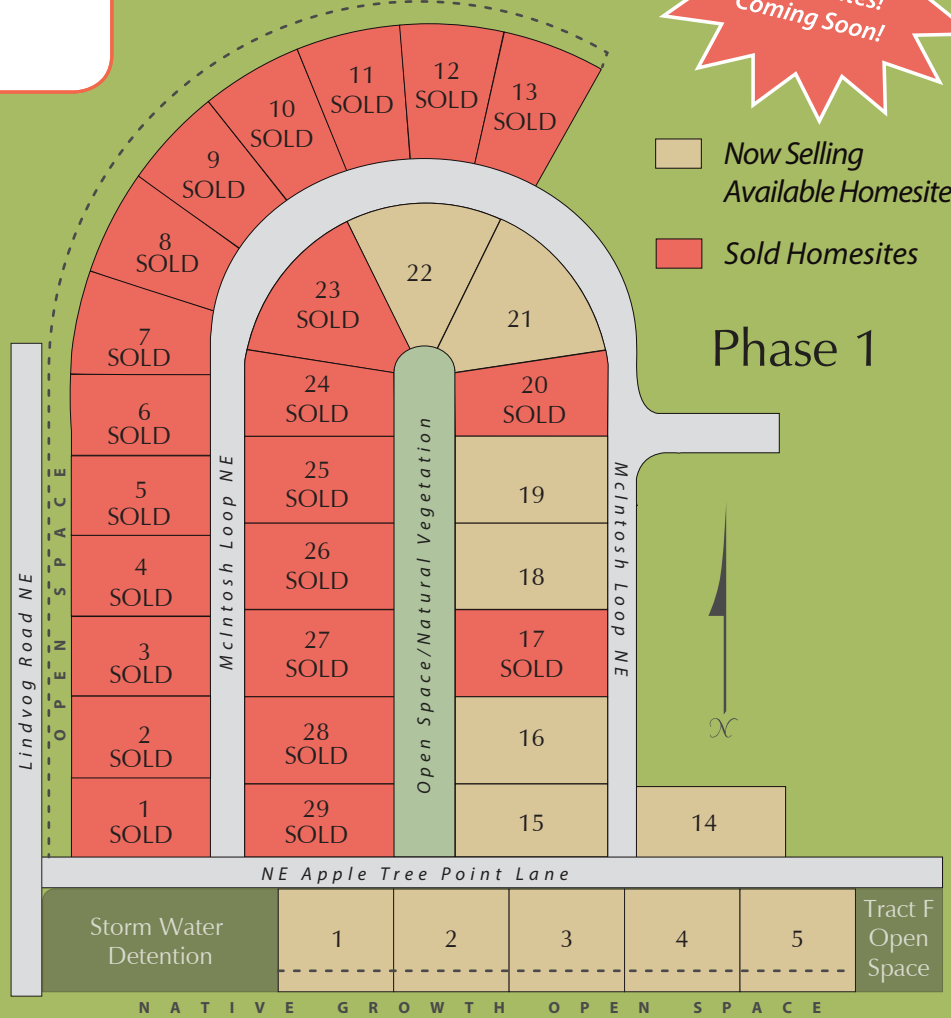

Buyer shall have free consultation time with Builder for Custom Home.

Homeowner Association dues are \$500/year.

- *Enjoy this small quiet coastal town with kayaking, golfing, hiking, and great beach combing.*
- *Minutes to downtown Kingston and ferry.*

Contact
Donna Courter
Managing Broker

Email: donnamcourter@gmail.com | Phone: 360-990-4095 | website: www.mykitsaphomes.com

Where you want to live.

How you want to live.



Directions to The Highlands at Apple Tree Point

From Kingston Ferry: 1.7 miles, WA Hwy 104 E/NE to Lindvog Road NE; go north to entrance of Apple Tree Point to 27853 McIntosh Loop, NE Kingston, WA 98346.

From South Kitsap Bainbridge Island or Poulsbo: 10.6 Miles

From: Hwy 3, to WA Hwy 307 to Hwy 104 NE to Lindvog Road NE, go north. to entrance of Apple Tree Point, 27853 McIntosh Loop, NE